



*Onomatopoeic
Audio Device
In Toilet*



Contents

- Product Origin
- Suggestions
- Product Illustration
- Package Contents
- Cautions
- Installation
- Instructions to Use
- Specifications

Instructions:

In order to optimise the device's function for customers, please follow exactly the steps in this manual when installing the device. After installation, please explain to the consumers instructions on using the device.

Product Origin

Water is one of the most important resources to us all. Like all living things, humans cannot survive without it. Yet the supply of clean and safe water is finite as evidenced by increasing hose-pipe bans and rising utility prices.

Therefore each person shares both an ethical duty and financial obligation to not waste water wherever possible.



Suggestions

INKEE suggest that everyone can contribute to protecting our natural resources, and that this need not mean public discomfort or embarrassment. Investing in green technologies such as the INKEE provide us with a means to do our bit. Protecting our world 12 litres at a time!

Product Illustration

Names of different parts

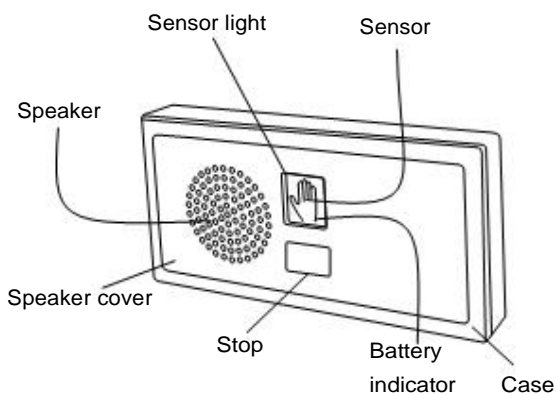

Dimensions

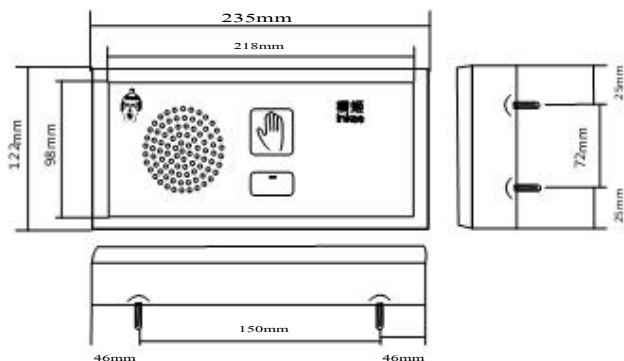

Package Contents

Name	Inkee	Installation Manual	Sucker-cup Fixture	Screws	Warranty Card	Battery
Quantity	1 pcs	1 pcs	1 pcs	1 pcs	1 pcs	4 pcs

Installation Attentions

- > Add a 30mm thick assistant composite board or 12mm plywood to the wall before installation if the wall too thin. Or it may cause the device fall down. > If the installation wall is made of concrete please use resin plug.
- > Use only the screws supplied in this package.
- > Make sure the device is firmly attached to the wall.
- > Do not install the device in a humid place such as outdoors or in a bathroom.

WARNING Please do not use under in following environments:

- Dusty, vibrative places
- Flammable, corrosive places



■ Installation place

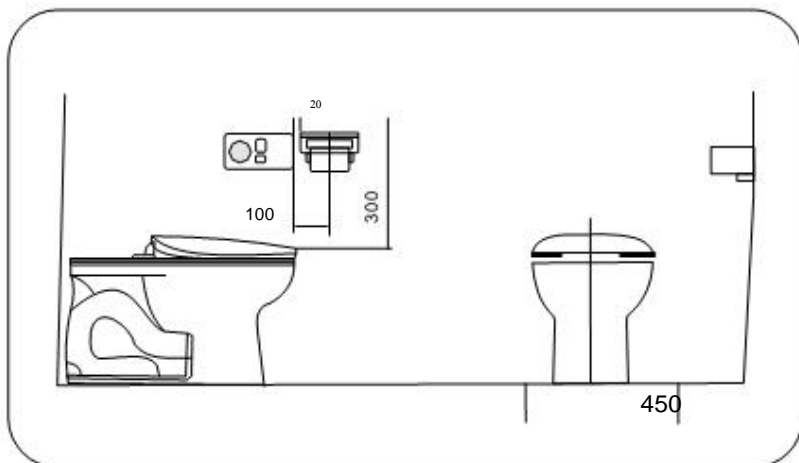

>Please install the INKEE within a reasonable clear area, away from any obstacles (around 115mm radius in front of INKEE) For example:

- 1.Toilet Fixtures (e.g. storage shelf, handrail)
- 2.Areas with movable objects (e.g. toilet roll dispensers with hinge top refill covers)
- 3.Areas covered by towels or toilet paper
- 4.Areas utilized by the person's body for the toilet's usage. This includes entrance and egress from the toilet and also spaces where hands, wrists and limbs may cross.

>Make sure there are no reflective items such as sensors, or mirrors installed facing or in front of the device.

>Do not install the device on vibrative surfaces. Examples may include places adjacent to vibrative machinery or locations near doors.

>Foreffective use of the device, please do not install in places where there are also other sensors.

>For a better user experience, do not install the INKEE where it may come within close proximity to any person's ears.

■ Installation

Step 1

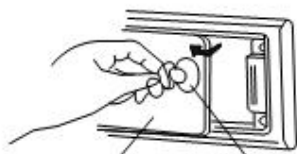

Picture 1

Speaker cover

Sucker-cup Fixture

Use the sucker-cup in the package to open the speaker cover. (Picture 1)

Step 2

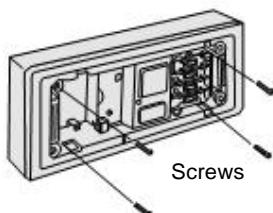

Picture 2

Screws

Use the 4 screws provided in the package to fix the device case to the wall. (Picture 2)

Step 3

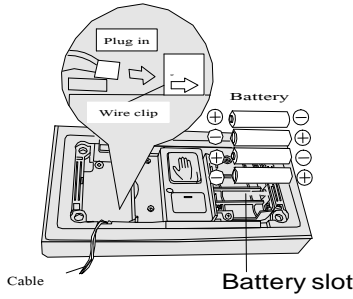

Picture 3

Install 4 x AA batteries appropriately into the battery slot. And plug the connecting cable into the wire clip. (shown in Picture 3)

Step 4

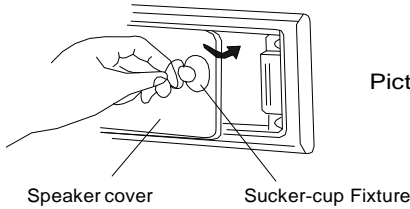

Picture 4

- >The speaker cover will be attracted by the magnets on the device case
- >Check that there is no space between the speaker cover and the device case.
- >After installation check that the device is firmly attached to the wall. (Picture 4)

Instructions to Use

■ How to use

- >Put a hand in front of the sensor will cause a flush sounds and last 25 seconds, then stop.
- >The green light will be on along with the flush sound. The time left of the flush sound is indicated by the speed of green light flashing quicker.
- >Place a hand in front of the sensor again during the 1st flushing sound for longer flushing time

■ Cautions

- >The device won't work properly below an environment temperature of -10 degrees Celsius.
- >Avoid shock towards the sensor and the stop buttons.
- >Do not stick any tape over the sensor. Should this occur the green light will flash to request that the obstruction be removed.

■ How to adjust volume

Use the sucker-cup to pull off the speaker cover, adjust volume using a screw driver. (Picture 5)

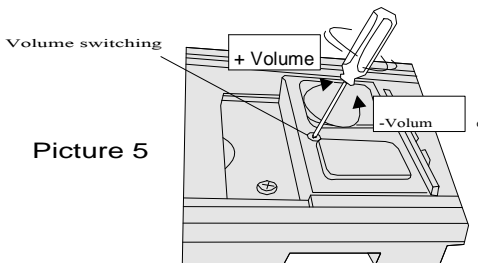

Picture 5

Make sure turn the screw driver gently.

Cautions

■ Different battery indicator lights

Replace batteries when the red light is flashing. (note: do not use rechargeable batteries)

Read the following notes to ensure against battery acid leaks:

> Place batteries according to '+' and '-' signs in the battery slot >

Do not use new and old batteries together

> Do not use a different size of battery to those supplied

> Inspect the device regularly for any signs of damage

> Replace and recycle batteries when they are used up. If the device is not used in a long time, remove the batteries.

IMPORTANT:

Avoid any contact of battery acid with the skin or eyes. If contact occurs, rinse thoroughly with water and contact medical help immediately. Failure to follow this guidance may result in irritation and pain, damage to skin and eyes, and loss of sight.

■ Maintenance

> Make regular maintenance.

> Wipe the unit when it's getting dirty with a soft lint-free cloth. > Do

not use bleach, thinner or alcohol on the unit.

> Do not allow the unit to make contact with water, including washing the unit directly under water. Failure to comply with this guidance may result in an electrical fire or shock.

■ Warranty card

> Always keep a full record on the warranty card. Make sure all details of the retailer, installation company and installation date have been recorded. Keep the warranty card in a safe place for future reference.

> Please see details on warranty card

■ Troubleshooting

> If the unit has stopped working, contact the retailer or the installation company. Please do not try to fix it yourself. This will invalidate the warranty.

> Check whether the unit has stopped due to reasons listed below:

Faults	Reasons	Solutions
Place a hand in front of the sensor, light is on but no flushing sound	Volume is too low	Adjust volume (See section 'How to adjust the volume')
	battery run out	replace with new battery
Put a hand above the sensor, no light nor flushing sound.	battery mis-placed	place battery according to '+' and '-' signs
	hand is too far away from the sensor	place a hand nearer to the sensor
Green light flashing but no flushing sound	obstructions over the sensor	remove any obstructions

*If the unit is still not working after the above solutions, ask for a professional.

Do not disassemble the unit, otherwise fire or electric shock might happen and any warranty will be invalid.

Specifications

	Power	Battery type
Power source	AC100V,50/60Hz (consumption : 1W)	4 x AA batteries
Working temperature	-10~40 degree Celsius	
Sound type	Flushing sound	
Sensor range	Around 115mm(fixed)	
Sound lasting time	first time: 25 seconds (put a hand above the sensor during the flushing sound can prolong it for further 23 seconds)	
Battery life	/	about 3,500 times of flushing

*Battery life time is varied due to different battery type, temperature and user frequency.